

Santa Cruz County DPW Burst ACP Pipe Locations:

Excavations Require Monterey Bay Air Resources District Notification

[SC DPW Asbestos Pipe Protocol](#)

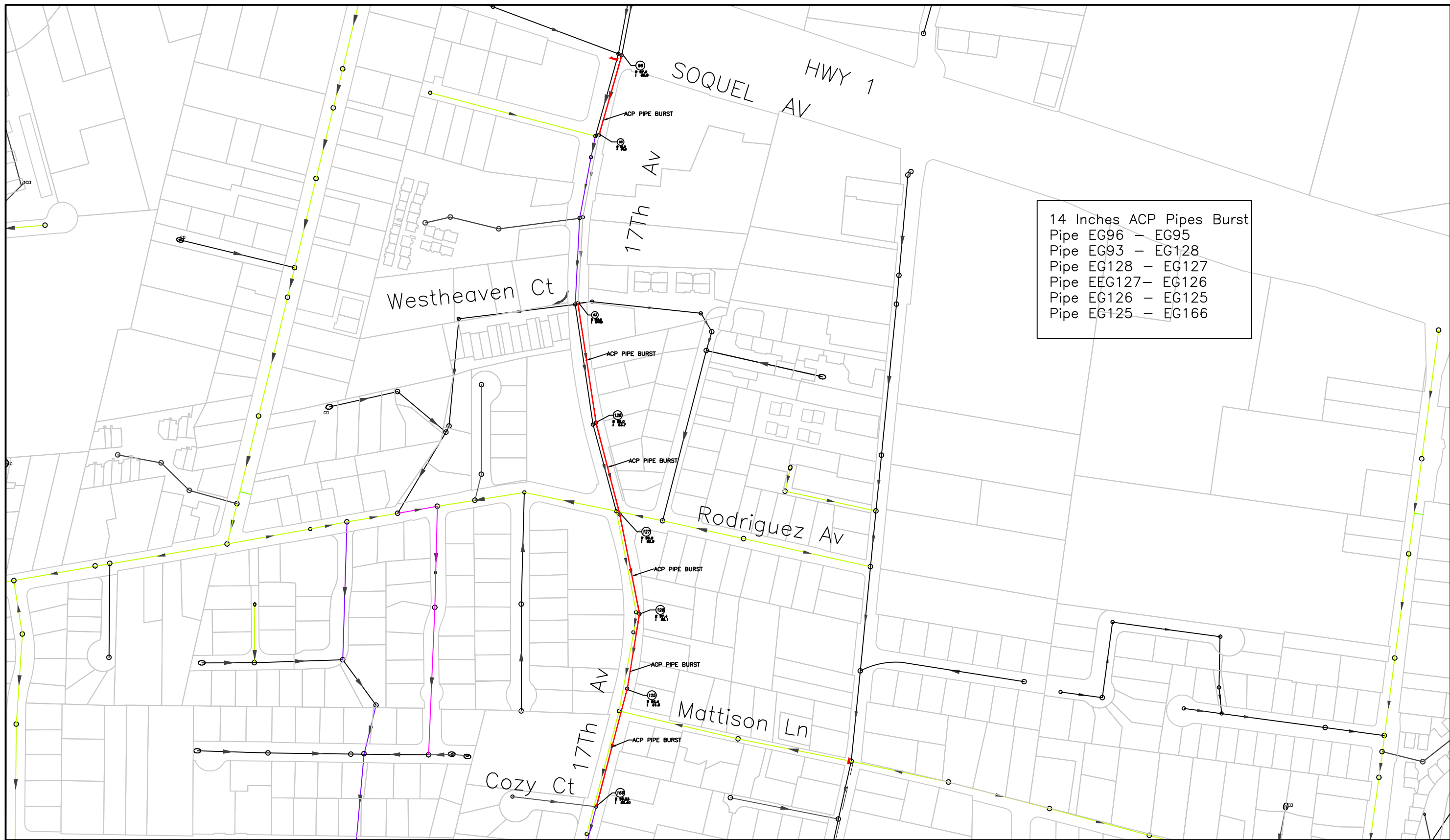

- 14 Inches ACP Pipes Burst
- Pipe EG96 - EG95
 - Pipe EG93 - EG128
 - Pipe EG128 - EG127
 - Pipe EEG127 - EG126
 - Pipe EG126 - EG125
 - Pipe EG125 - EG166

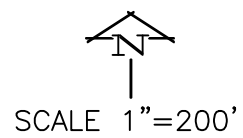

Note:
 Trenching within 1 foot of burst ACP pipe requires 45-day notice to the Monterey Bay Air Resources District. Refer to "Dept. of Public Works Protocol for Road Opening/Trenching Projects in Areas of Pipe Burst Asbestos Cement Pipe/ACP" for more information

SANTA CRUZ COUNTY SANITATION DISTRICT
 ACP PIPE BURST

17th Av and Soquel Av

RIM AND INVERT ARE NOT TO BE USED FOR CONSTRUCTION USE IT FOR REFERENCE ONLY

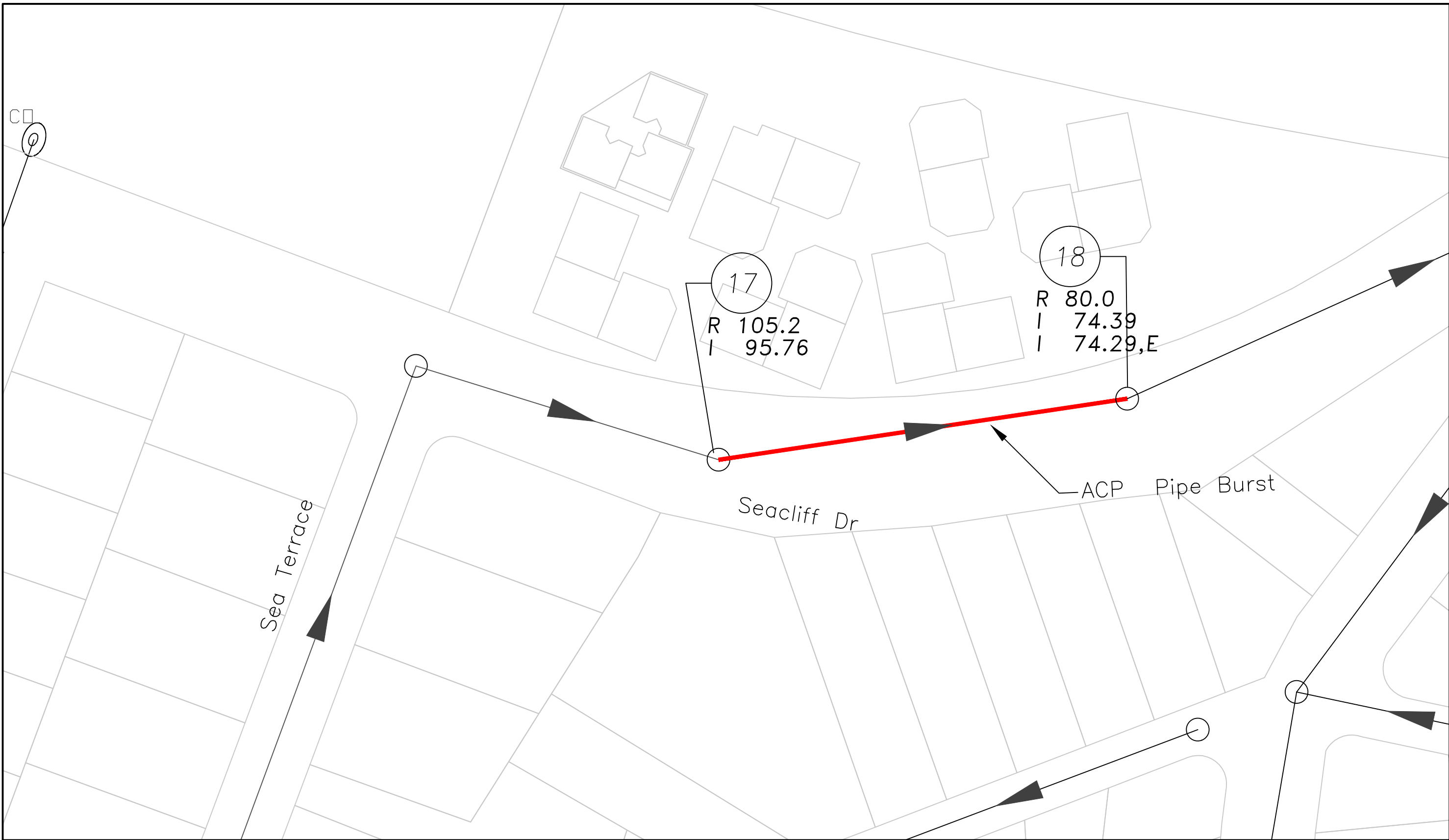

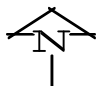

 SCALE 1"=50'

Note:
 Trenching within 1 foot of burst ACP pipe requires
 45-day notice to the Monterey Bay Air Resources
 District. Refer to "Dept. of Public Works Protocol for
 Road Opening/Trenching Projects in Areas of Pipe Burst
 Asbestos Cement Pipe/ACP" for more information

SANTA CRUZ COUNTY SANITATION DISTRICT
 ACP PIPE BURST
 Seacliff Dr and Sea Terrace

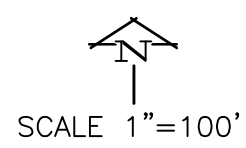
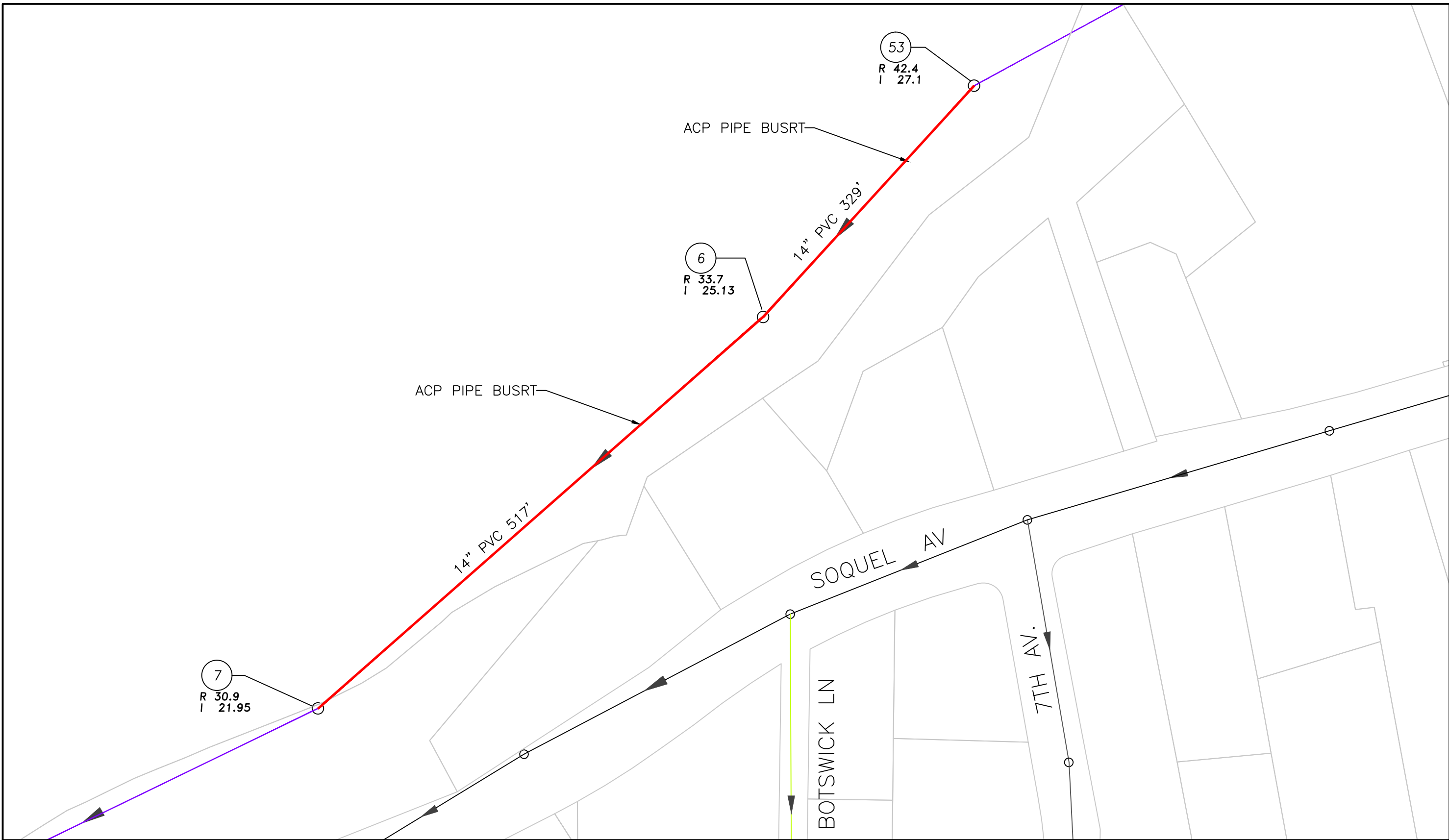
RIM AND INVERT ARE NOT
 TO BE USED FOR CONSTRUCTION
 USE IT FOR REFERENCE ONLY



Note:
 Trenching within 1 foot of burst ACP pipe requires 45-day notice to the Monterey Bay Air Resources District. Refer to "Dept. of Public Works Protocol for Road Opening/Trenching Projects in Areas of Pipe Burst Asbestos Cement Pipe/ACP" for more information

SANTA CRUZ COUNTY SANITATION DISTRICT
 ACP PIPE BURST
 Pipe EE7/EE6 and EE6/EE53 Near
 Soquel Av and Botswick Ln

RIM AND ELEVATIONS ARE FOR REFERENCE ONLY AND NOT TO BE USED FOR CONSTRUCTION

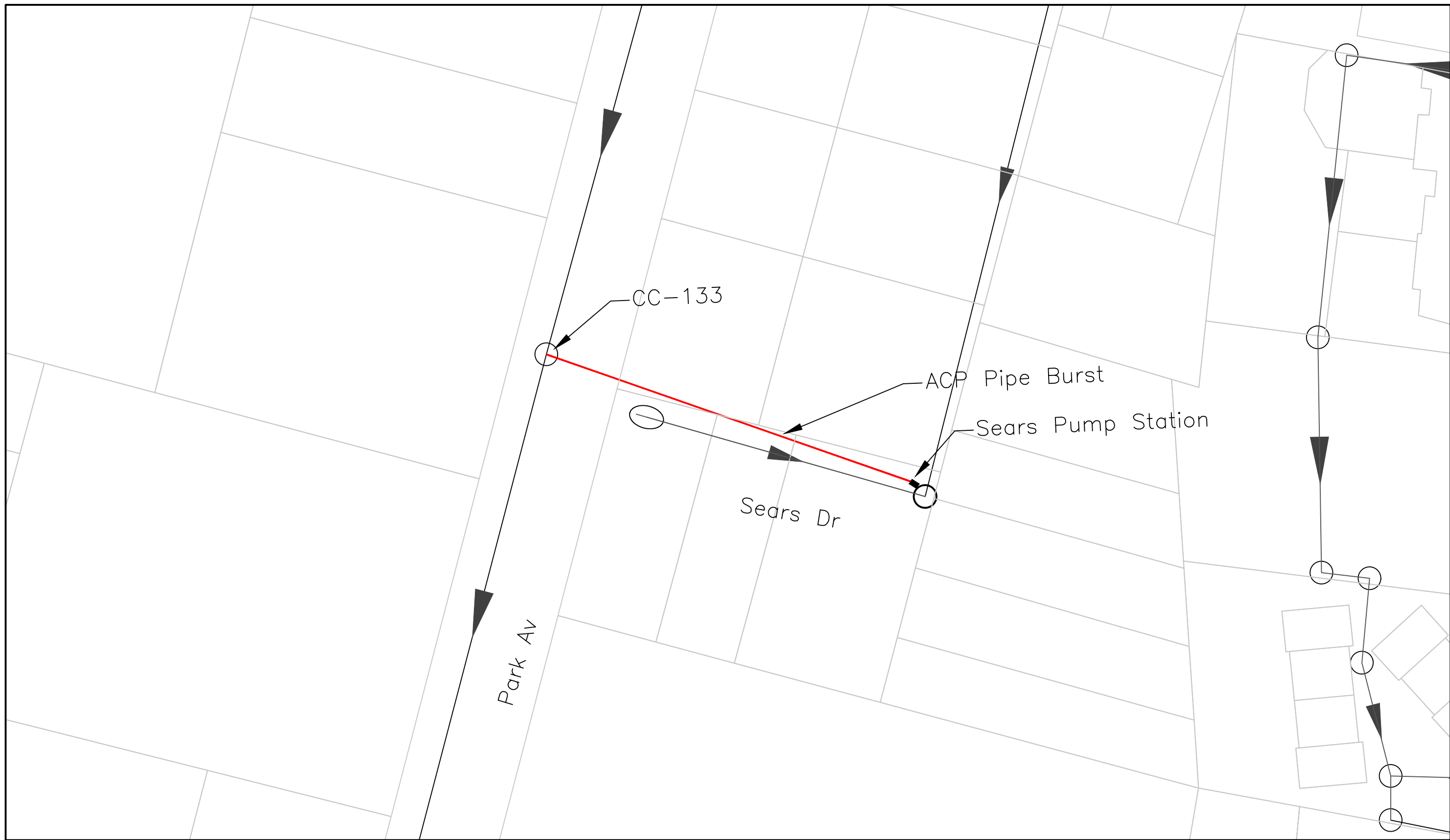

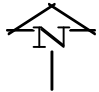
 SCALE 1"=50'

Note:
 Trenching within 1 foot of burst ACP pipe requires 45-day notice to the Monterey Bay Air Resources District. Refer to "Dept. of Public Works Protocol for Road Opening/Trenching Projects in Areas of Pipe Burst Asbestos Cement Pipe/ACP" for more information

SANTA CRUZ COUNTY SANITATION DISTRICT

ACP PIPE BURST
 Sears Force Main

RIM AND INVERT ARE NOT
 TO BE USED FOR CONSTRUCTION
 USE IT FOR REFERENCE ONLY

8-23-2018
 Created by RGH

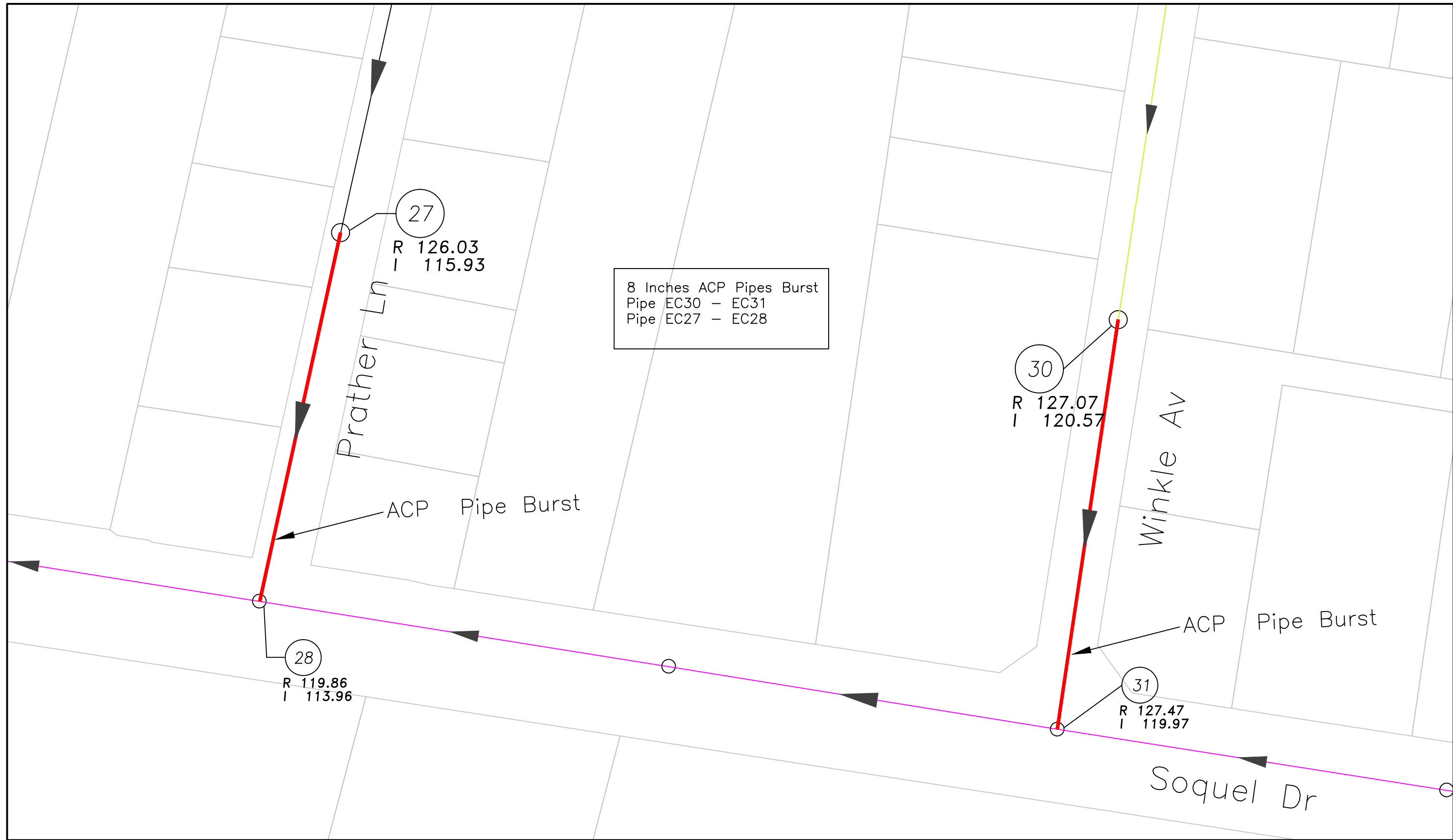

SCALE 1"=200'

Note:
 Trenching within 1 foot of burst ACP pipe requires 45-day notice to the Monterey Bay Air Resources District. Refer to "Dept. of Public Works Protocol for Road Opening/Trenching Projects in Areas of Pipe Burst Asbestos Cement Pipe/ACP" for more information

SANTA CRUZ COUNTY SANITATION DISTRICT
 ACP PIPE BURST
 Soquel and Winkle Av / Prather Ln

RIM AND INVERT ARE NOT TO BE USED FOR CONSTRUCTION USE IT FOR REFERENCE ONLY

- 8 Inches ACP Pipes Burst
- Pipe EP47 - E339
 - Pipe EP39 - EP40
 - Pipe EP40 - EP28
 - Pipe EP28 - EP19
 - Pipe EP19 - EP10
 - Pipe EP10 - EP 7
 - Pipe EP7 - EP11
 - Pipe EP7 - EP3

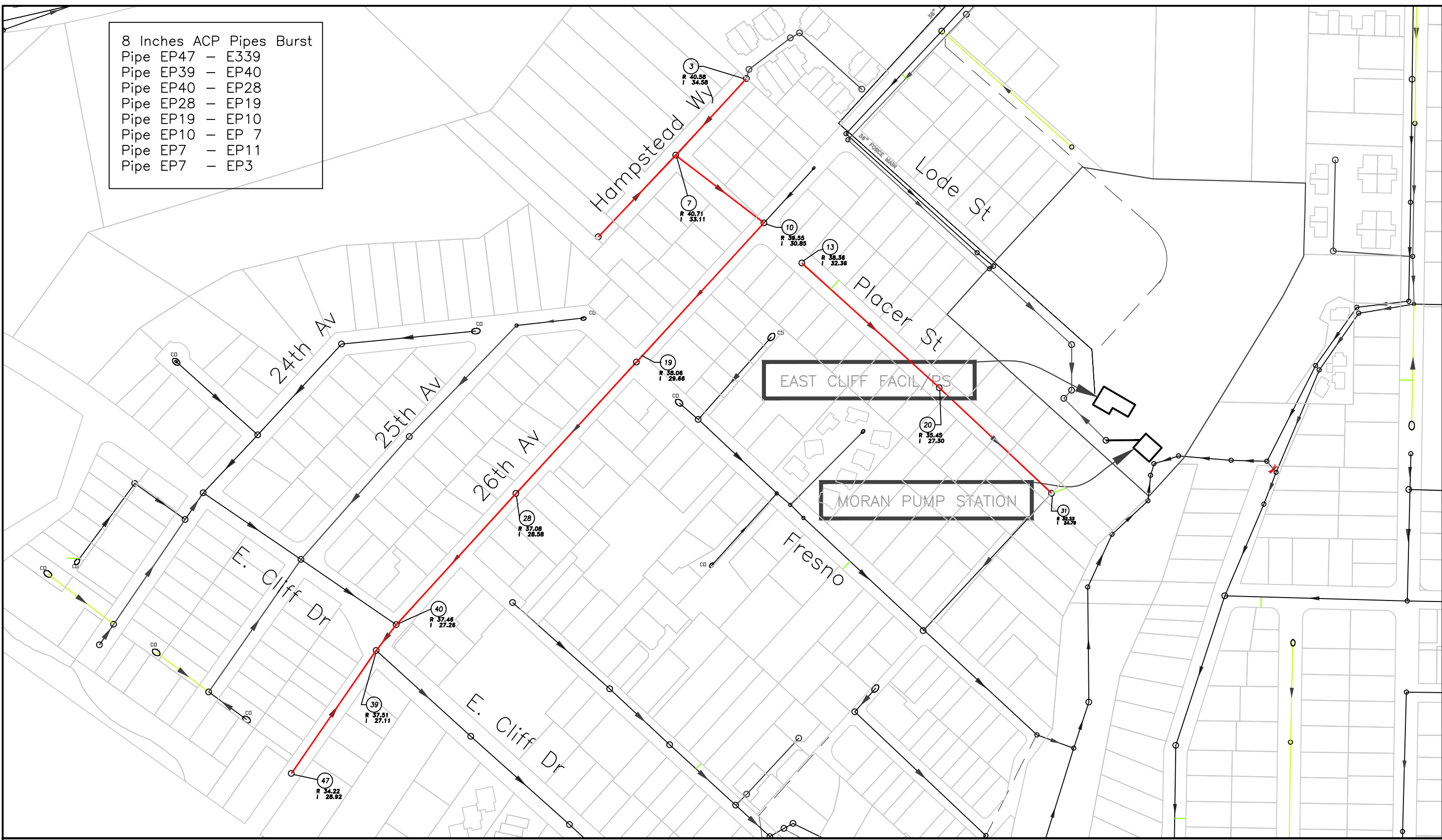

SCALE 1"=200'

Note:
Trenching within 1 foot of burst ACP pipe requires 45-day notice to the Monterey Bay Air Resources District. Refer to "Dept. of Public Works Protocol for Road Opening/Trenching Projects in Areas of Pipe Burst Asbestos Cement Pipe/ACP" for more information

SANTA CRUZ COUNTY SANITATION DISTRICT
ACP PIPE BURST
Twenty Six Ave

RIM AND INVERT ARE NOT TO BE USED FOR CONSTRUCTION USE IT FOR REFERENCE ONLY

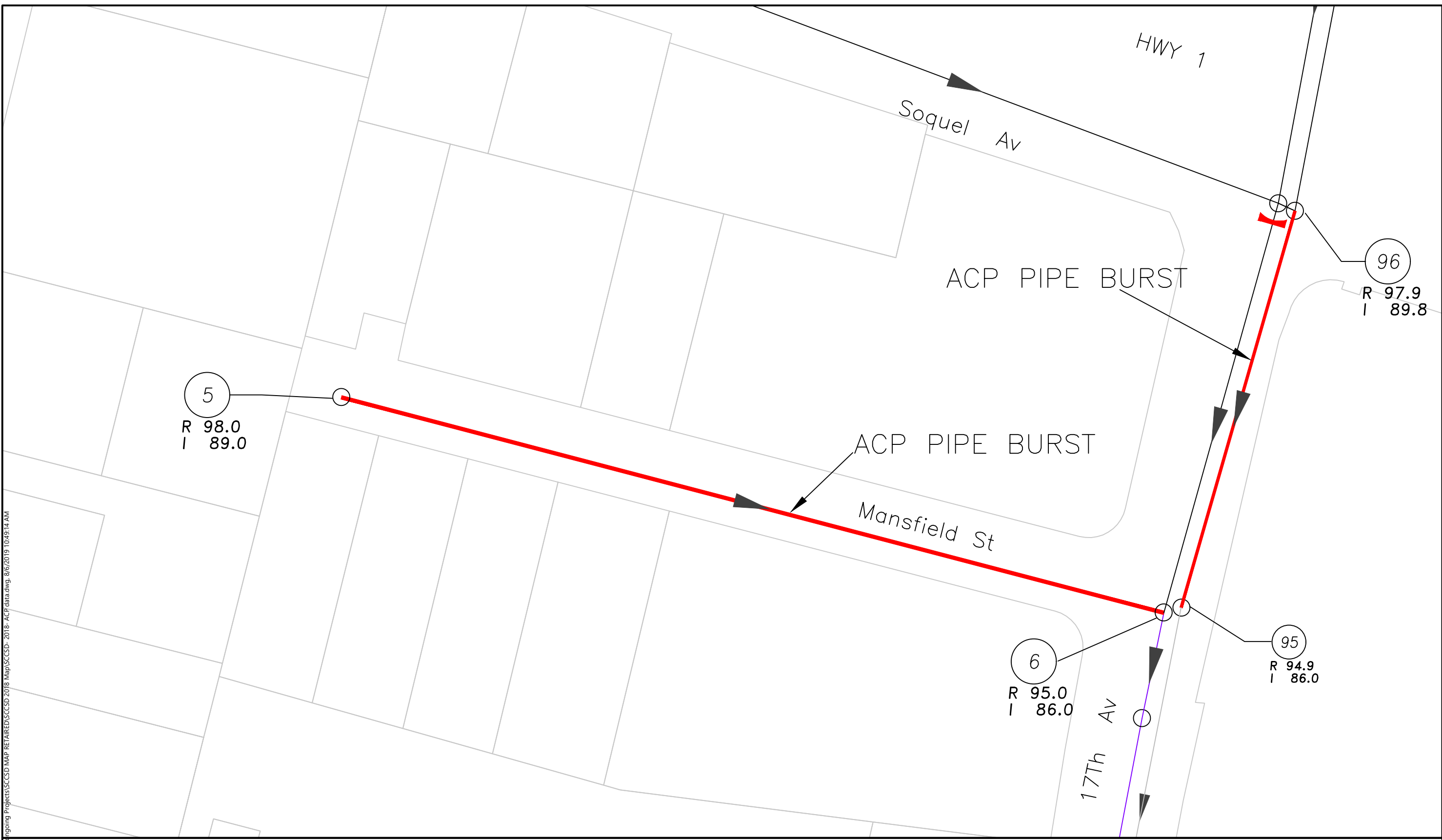

D:\pww\17\data\ODE\Reve Sewer Maps and Enging Projects\SCCSD MAP RETAILED\SCCSD 2018 Map\SCCSD - 2018 - ACP data.dwg, 8/6/2019 10:49:14 AM

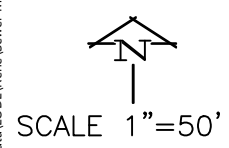

Note:
 Trenching within 1 foot of burst ACP pipe requires 45-day notice to the Monterey Bay Air Resources District. Refer to "Dept. of Public Works Protocol for Road Opening/Trenching Projects in Areas of Pipe Burst Asbestos Cement Pipe/ACP" for more information

SANTA CRUZ COUNTY SANITATION DISTRICT
 ACP PIPE BURST
 Mansfield St and 17Th Ave

RIM AND INVERT ARE NOT TO BE USED FOR CONSTRUCTION USE IT FOR REFERENCE ONLY

8-6-2019
 Created by RGH

DANUBE D

VIENNA DR

17
R 394.0
I 387.95

S=1.92% C=1.079

ACP PIPE BURST

8" VCP 34P'

18
R 390.0
I 381.41

JENNIFER DR

8" VCP 318'

C=0.8

S=0.85% C=0.7

19
R 389.
I 384

8" VCP

SCALE 1'=50'

Note:
Trenching within 1 foot of burst ACP pipe requires 45-day notice to the Monterey Bay Air Resources District. Refer to "Dept. of Public Works Protocol for Road Opening/Trenching Projects in Areas of Pipe Burst Asbestos Cement Pipe/ACP" for more information

SANTA CRUZ COUNTY SANITATION DISTRICT
ACP PIPE BURST
Vienna Dr

RIM AND INVERT ARE NOT TO BE USED FOR CONSTRUCTION USE IT FOR REFERENCE ONLY

5-06-2021
Created by EFE